

Rear Ends | Suspensions | Axles | Brakes

- *Please read instructions thoroughly before assembly.
- *Please confirm all parts are accounted for before you start!
- *See the Diagram below for the order of assembly.
- *Tools Required: Drill, 3/8" Drill Bit, 9/16" Wrench, 9/16" Socket Wrench

***Some caliper brackets have a raised bump that doesn't allow the spacer and Retainer plate to sit flush. If yours is this way be sure to grind it off to allow Proper installation or bearing failure could occur.**



- Step 1) Remove ABS rings from OEM Axles.
- Step 2) Press ABS Rings onto your new Moser Axles.
- Step 3) Slide the wheel bearing and then the press ring onto the shaft. Make sure the O-ring on the bearing goes toward the wheel.
- Step 4) Press Bearing and Press Ring on to Axles. (Requires a minimum 10 ton press)
- Step 5) Identify Caliper Brackets as Left (Drivers Side) and Right (Passenger Side)
- Step 6) Drill out the four bolt holes in each caliper bracket with a 3/8" bit.
- Step 7) Slide the Right Caliper Bracket over the Passengers Side Axle.
 (The Passenger Side Axle will be the longer of the two Axles)
 (Repeat for Right or Drivers Side Axle)
- Step 8) If you are using inner housing seals, install them into the housing ends.
- Step 9) Slide the axles into the housing. The axle should slide all the way in so that the bearing is flush with the end of the housing.
- Step 10) Install and tighten the ABS Sensor to the Caliper Bracket.
- Step 11) Slide #9705 Retainer Plate and #91905 Shim on Axles. They are slotted to fit onto the axles after the bearings are installed.
- Step 12) Secure the Retainer Plate and Caliper Bracket by using the provided 3/8"-24 Bolts and Nuts.

- Parts List:**
- 2 - Wheel Bearings
 - 2 - Press Rings
 - 2 - #9705 Retainer Plates
 - 2 - #91905 Shims
 - 8 - 3/8"-24 Grade 8 Bolts

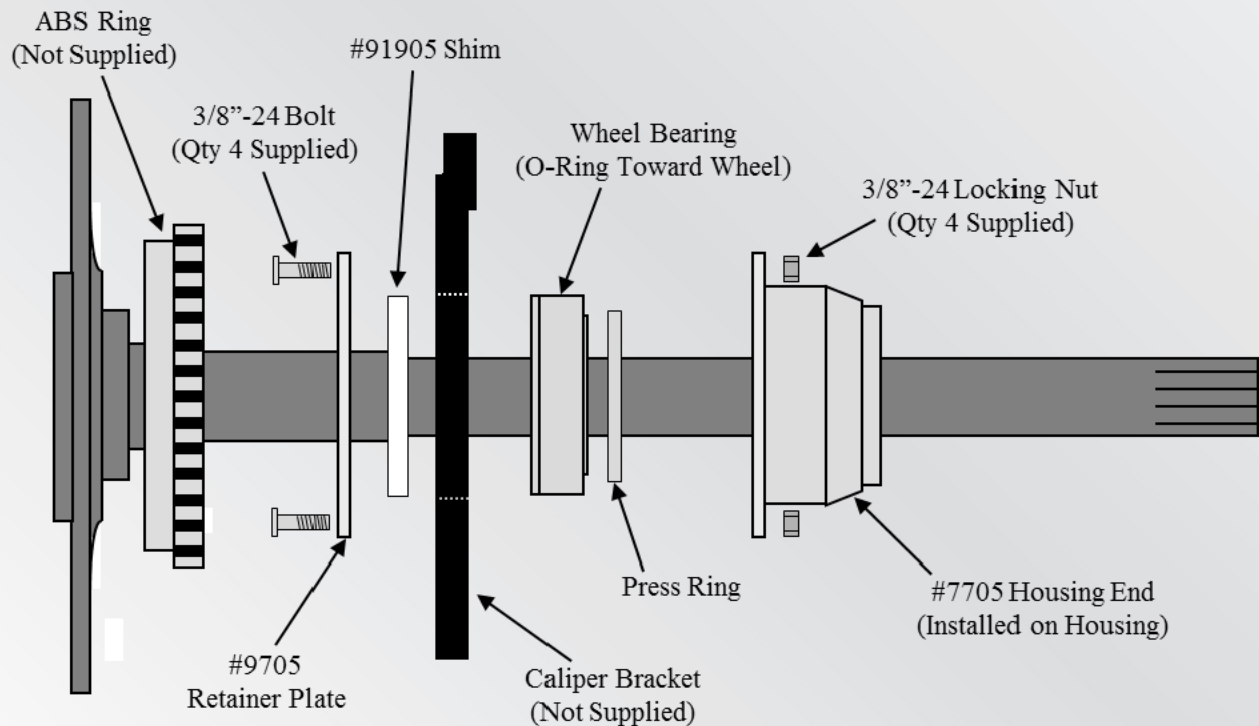

IN19-02